

# Geoprobe® 7822DT Drill Rig

## The Industry Benchmark for Direct Push Equipment

The Geoprobe® 7822DT is a high-capacity direct push machine with a narrow platform. Applications include soil sampling, rock coring, groundwater monitoring, geotechnical and more.

▶ VIDEOS AVAILABLE AT [GEOPROBE.COM/7822DT](http://GEOPROBE.COM/7822DT) WHEN YOU SEE THIS SYMBOL

### ▶ Two and Four Speed Rotary Head Options

- Rock coring compatible
- 2-speed augerhead (4,000 ft-lbf, 150 rpm)
- 4-speed augerhead (4,000 ft-lbf, 750 rpm)

### ▶ Automatic Drop Hammer Compatible (SPT)

Rear Blade (Stabilization & Tool Transport)

### ▶ Winch Mast

- Single and dual winch options available
- 2,500 lbf, 1,800 lbf, and 1,100 lbf winch options available

### ▶ Drill Mast

- Integrated drill mast oscillation

### ▶ Geoprobe® GH60 Series Percussion Hammer

- Modular percussion power cell technology

### ▶ Control Panel

- Integrated safety features

Wireless & Tethered Remote Drive

▶ Frame Rail Design for Adding Machine Accessories

## WEIGHT & DIMENSIONS

Base Unit Weight: 8,160 lb. (3,701 kg.)  
With Typical Options: 9,560 lb. (4,336 kg.)

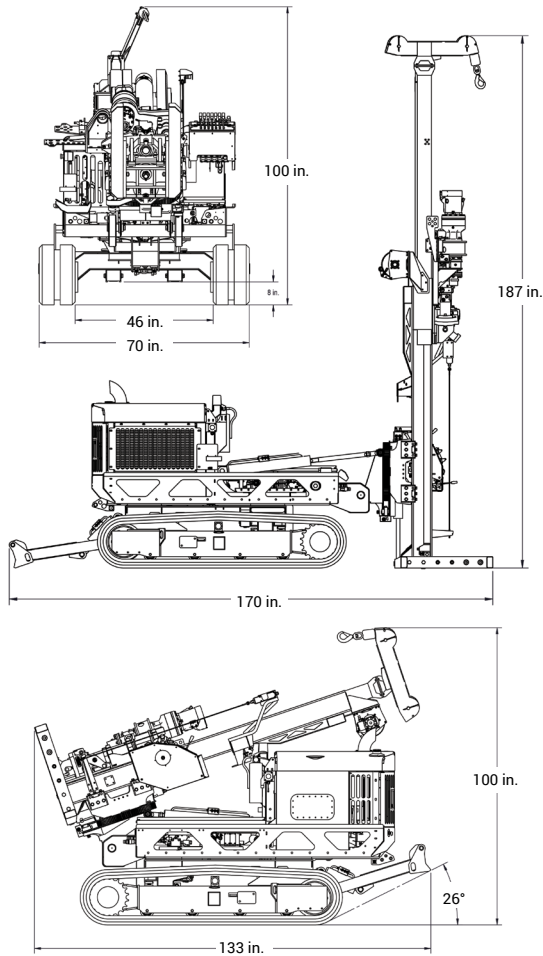

## TOOLING

### Typical Geoprobe® Tooling for the 7822DT

- 60-in. Direct Push Tooling
- Probe Rod Sizes: 3.75 in., 3.25 in., 2.25 in., 1.5 in., 1.25 in.\*
- Macro Core® Soil Sampling (MC5, MC7)
- Dual Tube Soil Sampling (DT37, DT325, DT22)
- Groundwater Sampling (SP22, SP16)
- Prepacked Monitoring Well Installations (2.0 in., 1.5 in., 1.0 in., 0.75 in.)
- HSA System (4.25 in. and 6.25 in.)
- Direct Image® Tooling
- SPT Sampling (Interlocking Split Spoon Sampler, Driven Casing SPT, HSA, Solid Auger, Mud Rotary)

\* Center Rod Use Only  
Rig shown with optional features. Weights & dimensions subject to change without notice.



## OPTIONS

### Rotary Head

- 2-Speed Rotary Head (4,000 ft-lbf, 150 rpm)
- 4-Speed Rotary Head (4,000 ft-lbf, 750 rpm)

### Mast / Winch

- Dual Winch Kit
- Winch Kit: 2,500 lbf
- Winch Kit: 1,800 lbf with Quick Change Hook
- Winch Kit: 1,100 lbf with Quick Change Hook
- Fixed Mast Top
- Rotating Mast Top
- 3 ft. Mast Extension

### Breakout

- 7 in. Breakout Kit
- Coring Upgrade Kit for 7 in. Breakout
- Portable Hydraulic Rod Clamp

### Rotational Safety Cage

- Safety Cage

### Automatic Drop Hammer

- Automatic Drop Hammer, 140 lb.
- Automatic Drop Hammer, 65 kg
- Expansion Kit
  - 340 lb.
  - 300 lb.
  - 170 lb.
- Anvil Hanger

### Water Swivels

- High Speed Water Swivel with Float
- Float Sub NWJ Pin Assembly
- Float Sub NWL Pin Assembly
- Float Sub HWL Pin Assembly
- King Oil Water Swivel

### Control System

- Head Feed Pressure Control Kit
- CPT Valve Kit

### Water / Mud Pumps

- Moyno® 2L4 Pump Kit
- Moyno® 3L6 Pump with Table
- Triplex Pump Kit
- SPX40 Pump & Mount Assembly
- Control Panel Gauge Mount Kit

### Hydraulic Extruder

- 5 ft. Hydraulic Extruder
- 3 in. Shelby Tube Cradle
- 5 ft. Extruder with Moyno® 2L4 Pump - Operator Side
- 5 ft. Extruder with Moyno® 2L4 Pump - Helper Side
- 5 ft. Extruder with Moyno® 3L6 Pump - Helper Side
- 5 ft. Extruder with Moyno® 3L6 Pump - Operator Side

### Rod Racks

- Locking Side Rod Rack - Helper Side
- Locking Side Rod Rack - Operator Side
- Side Mount Rod Rack
- Swing Out Rod Rack - Helper Side
- Side Rack Mount Blank
- Drop Rack System with Rod Rack
- Drop Rack System with Utility Rack
- Drop Rack System with 50 Gal. Pressure Washer System

Additional drop rack, toolbox, mud pan, and other options are also available. Call us for more information.

